

Soils Map

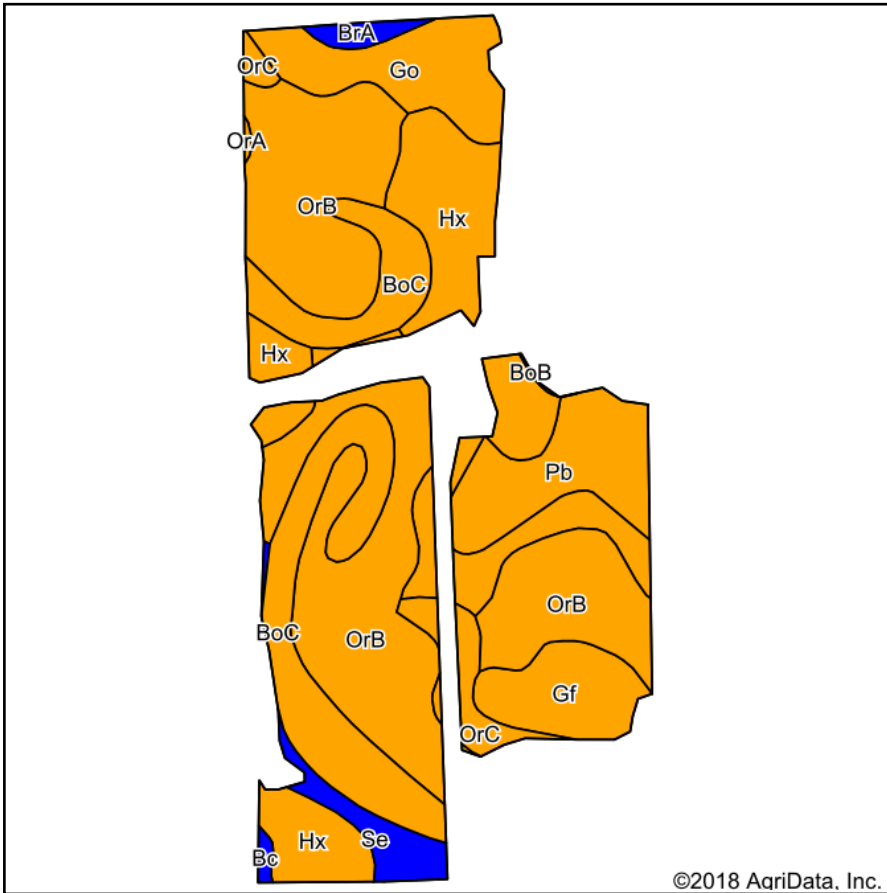

Soils data provided by USDA and NRCS.

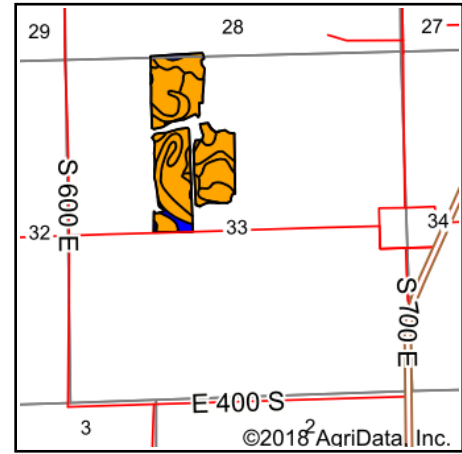

State: **Indiana**
 County: **Kosciusko**
 Location: **33-32N-7E**
 Township: **Washington**
 Acres: **53.52**
 Date: **4/17/2018**



Area Symbol: IN085, Soil Area Version: 20

Code	Soil Description	Acres	Percent of field	Non-Irr Class Legend	Non-Irr Class *c	Irr Class *c	Soybeans	Corn
OrB	Ormas loamy sand, 2 to 6 percent slopes	20.04	37.4%		IIIe		35	100
BoC	Boyer loamy sand, 6 to 12 percent slopes	8.26	15.4%		IIIe	IIIe	29	82
Hx	Houghton muck, drained	7.90	14.8%		IIIw		42	159
Gf	Gilford sandy loam, gravelly substratum	5.44	10.2%		IIIw		33	150
Pb	Palms muck, gravelly substratum, drained	4.24	7.9%		IIIw		42	160
Go	Gravelton loamy sand, occasionally flooded	3.92	7.3%		IIIw		18	105
OrC	Ormas loamy sand, 6 to 12 percent slopes	1.53	2.9%		IIIe		32	90
Se	Sebewa loam, drained, 0 to 1 percent slopes	1.47	2.7%		IIw		37	133
BrA	Bronson sandy loam, 0 to 2 percent slopes	0.50	0.9%		IIIs		38	108
Bc	Barry loam	0.16	0.3%		IIw		49	175
OrA	Ormas loamy sand, 0 to 2 percent slopes	0.06	0.1%		IIIs		35	100
Weighted Average							34.3	117.1

*c: Using Capabilities Class Dominant Condition Aggregation Method

Soils data provided by USDA and NRCS.